

# Idle Free Systems Update to Harness

## **Battery Fuse:**

To improve product safety there is a new harness routing required to be installed between the APU battery bank and the Reefer Link.

Your installation will depend on the battery configuration; please see the suitable instructions below.

If your APU is a Series 2000 (HVAC), 3000 (Slimline) or 4000 (BTC) please use the instructions on this page.  
Series 1000 (BA600) please use the instructions on the following page.

## **Disconnect the negative battery cable. Then follow Instructions below.**



1. Disconnect the 3 black (-) connections shown left with an 'X'.
2. If installed previously, remove any Reefer Link cable from the red (+) Reefer Link connector that connects directly to the battery (+) terminal. (Not Shown).
3. Install the new cable from the red (+) Reefer Link connector to the red (+) APU connector as shown in the picture to the left.
4. Torque flange nuts to 65 in-lbs.



1. Reconnect all negative (-) cable connections. Torque flange nuts to 65 in-lbs.
2. Using cable ties secure both the black (-) cables and the red (+) cables.
3. Apply corrosion preventative to all contacts.

If your APU is a Series 1000 (BA600) please use the below instructions.

**Disconnect the negative battery cable. Then follow Instructions below.**

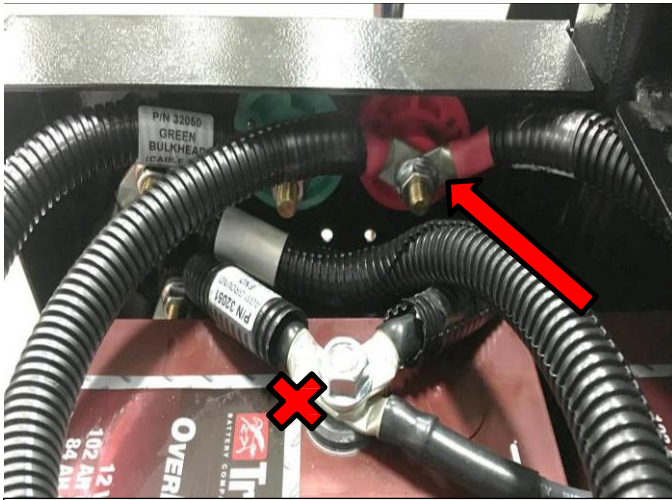

Disconnect the battery (-) connections shown in the above picture with an 'X'.  
If installed previously, remove any Reefer Link cable from the red (+) Reefer Link connector that connects directly to the battery (+) terminal. (Not Shown)

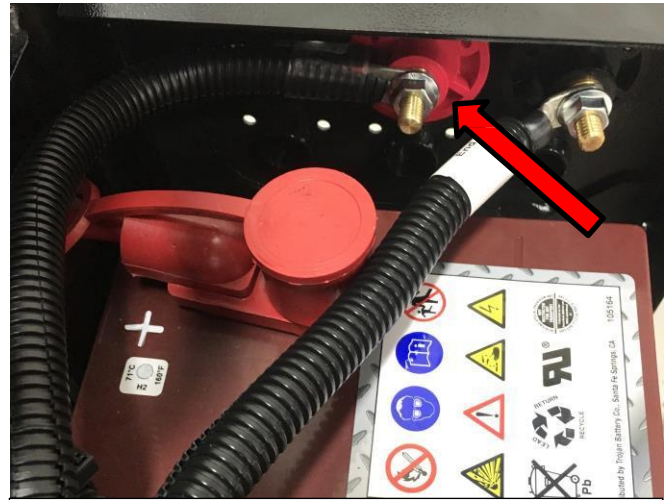

Install the new red (+) cable to its Reefer Link connector shown above. Install second end of new red (+) cable to APU red (+) connector (Left Picture Arrow). Torque flange nuts to 65 in-lbs.



The new red (+) cable should look like the above picture going across the APU battery box connecting to both red (+) connectors. Using cable ties secure the cable. Re-install the battery (-) connections. Apply corrosion preventative to all contacts.

## Reefer Link Installation Wiring Diagram

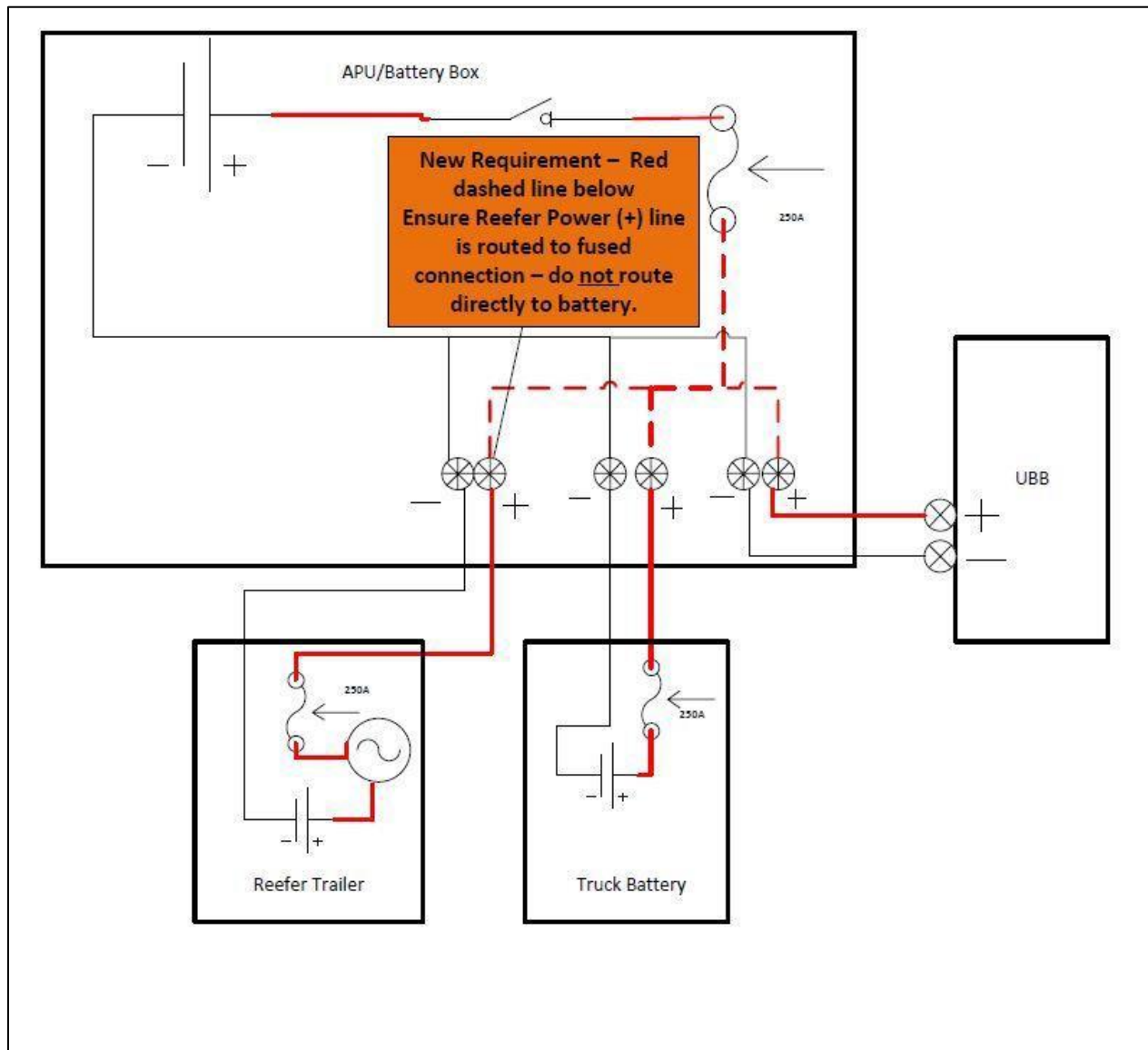

Ensure that the Reefer Link red (+) cable connects to the corresponding red (+) connector and not directly to the APU/Battery Box post. This circuit needs a fused power source as shown in the above schematic.